

### FEATURES



- Electronic type (Twist-lock Type) Photo Control
- High reliability, versatile, and long-life
- Multi-Volt Operation
- Meets or exceeds ANSI C136.10

### APPLICATION

Designated for all traditional roadway and area lighting applications and equipment.



### SPECIFICATIONS

Rated Voltage	120-277V (105-305V)
Frequency	50/60 Hz
Turn-On Light Level	10 Lux or at customer's request
Turn-Off Light Level	30 Lux or at customer's request
Optional Range OFF/ON Ratio	1:3
Time Delay ON/OFF	< 15s
Cap Color	Blue
Operating Temperature	-40°C ~ 70°C
MOV Surge Protection	320 Joules
Energy Consumption	Less than 1 Watt (120V<0.5W)
Electrical Life	5,000 Hours
Housing:	UV stabilized impact resistant polycarbonate (PC)
Fail Mode	OFF

### LOAD RATED

120V	50/60 Hz	8A, 960W Tungsten 9.8A, 1100VA Ballast (HID)
208V	50/60 Hz	8A, 1660VA Ballast (HID)
240V	50/60 Hz	8A, 1920VA Ballast (HID)
277V	50/60 Hz	2.4A, 660VA Ballast (HID)

### DIMENSIONS

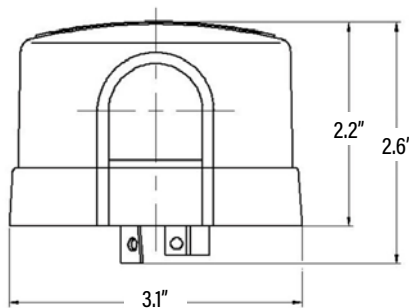

### ORDERING

ITEM#	DESCRIPTION	CASE
LFSTPC	PHOTO CONTROL FOR LED STEALTH™ FIXTURE 83585	1